

WINSMITH HELICAL BEVEL GEARBOX (HXB)

Modular, compact and efficient drive system designed for a variety of applications. Winsmith HXB Units are built to order with available stock inventory including available accessories which allow for quick shipment within 1-3 days from our Asheville, NC gearing facility.

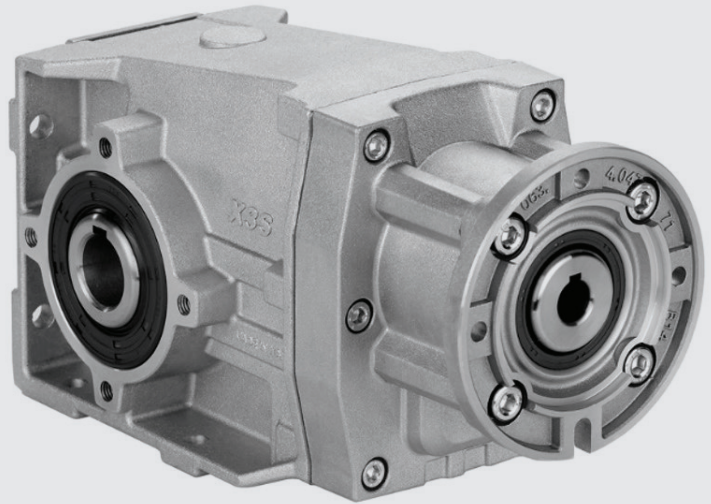

- Precision ground and hardened gears to provide optimal durability and efficiency, ensuring long operating life, low noise and minimal energy losses.
- Single-piece aluminum housing design which provides excellent corrosion protection and leak free operation. While it does not require a secondary finish, it easily accommodates paint for aesthetic purposes.
- Precision machining guarantees the proper alignment of bearings and gears, which is crucial for optimal operation and reliability.
- Featuring a removable inspection cover that facilitates regular gear inspections during maintenance, ensuring optimal performance over time.
- Fully modular design with input motor C Flange and input shaft for NEMA standard motors.
- Shipped with synthetic universal lubricant level.
- Standard options and accessories to accommodate a variety of mounting configurations.

HELICAL BEVEL GEARBOX (HXB)		
	Sizes	X32S, X42A, X52A, X62A
Ratio Range	2 Stage	7.33 to 77.36
	3 Stage	36.17 to 589.85
	Input Power	¼ to 10 hp
	Output Torque	797 to 3629 lb-in

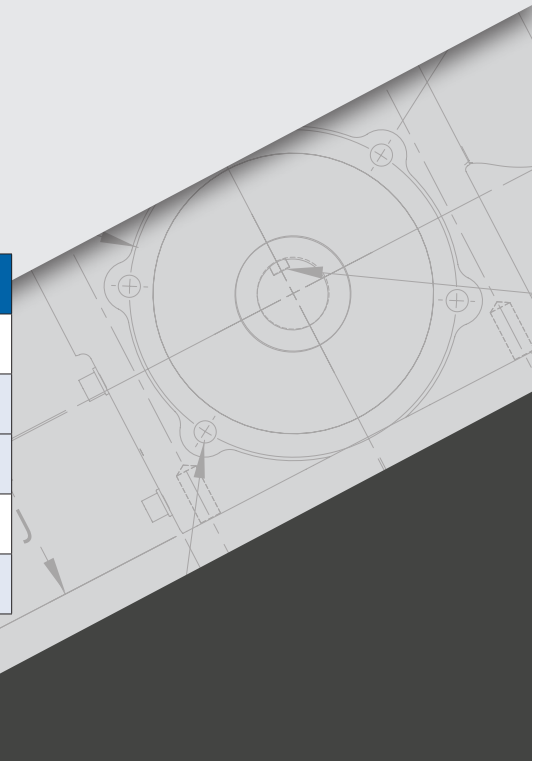

MODULAR BASE

SIZE (IN)	TORQUE (LB-IN)
X32S	797
X42A	1328
X52A	2213
X62A	3629

AVAILABLE ACCESSORIES



OUTPUT FLANGE



MOTOR FLANGE